



# ETON

ST LUCIA

**FOR SALE**

**UNIT 1 - LEVEL 0**  
3 BED 2 BATH + PATIO

**FLOOR AREA**  
INTERNAL 99m<sup>2</sup>  
BALCONY 20m<sup>2</sup>  
TOTAL AREA 119m<sup>2</sup>

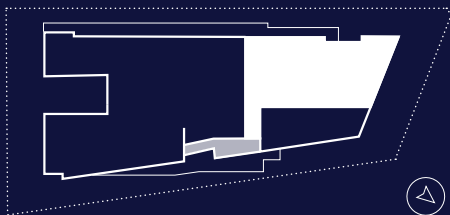

DISCLAIMER : Whilst care has been taken in the preparation of this document, no representation is made or accepted by The Developer or other interested parties for the accuracy or completeness of the information presented. This material is indicative only and is not intended to be a true representation. Changes may be made during the development without notice. The material in this document has been prepared solely for information purposes and is not intended to form part of any contract or constitute an offer or invitation to the public. Interested persons should make and rely on their own independent enquiries.





# ETON

ST LUCIA

**FOR SALE**

**UNIT 2 - LEVEL 1**  
**UNIT 6 - LEVEL 2**  
3 BED 2 BATH + PATIO

**FLOOR AREA**  
INTERNAL 91m<sup>2</sup>  
BALCONY 18m<sup>2</sup>  
TOTAL AREA 106m<sup>2</sup>

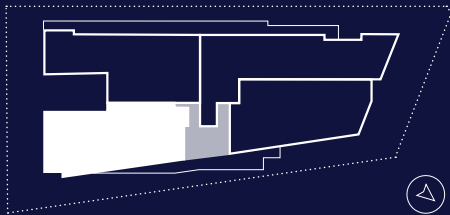

DISCLAIMER : Whilst care has been taken in the preparation of this document, no representation is made or accepted by The Developer or other interested parties for the accuracy or completeness of the information presented. This material is indicative only and is not intended to be a true representation. Changes may be made during the development without notice. The material in this document has been prepared solely for information purposes and is not intended to form part of any contract or constitute an offer or invitation to the public. Interested persons should make and rely on their own independent enquiries.